

9800 PTX to PT2X Rotary Joint Conversion

KA fluidhandling.kadant.com/en/knowledge-center/installation-and-repair-instructions/piston-type-pt-ptx-pt2x-rotary-joints/9800-ptx-to-pt2x-conversion

Effective: August 1, 2022



Introduction

Read all of the instructions before proceeding.

Refer to Kadant Johnson assembly drawing for part identification and to drawing A37640 for torque specifications. For easy identification, parts used in individual steps are often accompanied with their position in the assembly drawing [e.g. gasket (8B)]. Tighten all fasteners in a star pattern. Certified drawings are available upon request. Dimensions are for reference only and subject to change.

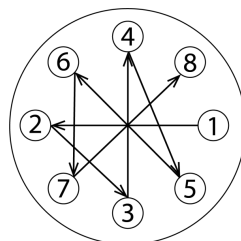

Safety

! This safety symbol alerts you to risk of death or injury if the instructions are not followed. In all steps, death or injury may result if the machine is not de-energized, depressurized, cooled, and stopped. Death or injury may occur if the product is operated with a fluid type or at a pressure, temperature, or speed that do not meet its specifications. Death or injury may occur if heavy parts and pinch hazards are not handled properly. Follow your company's safety procedures.

Step 1

Disconnect piping. Remove the head and set aside.

! Equipment must be cool and free of pressure.

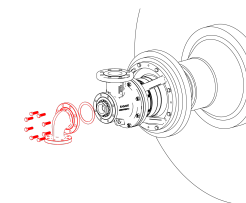

Step 2

Bend tabs back from hollow bolt.

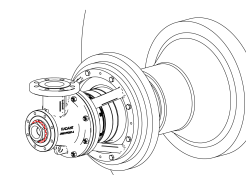

Step 3

Unthread the hollow bolt approximately 1/4" (6.4 mm). Place a block of wood over the hollow bolt and strike it with a hammer. This will break the tapered seal inside of the rotary joint. Remove the hollow bolt and set aside for reuse.

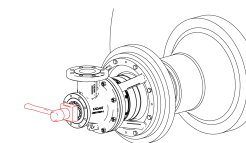

Step 4

Remove the body and set aside with the O-ring side up. Remove and discard the O-ring (26).

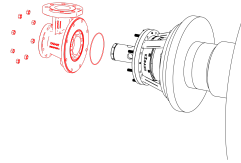

Step 5

Remove and discard the end cap assembly and seal ring.



Spring force present during endcap assembly removal.

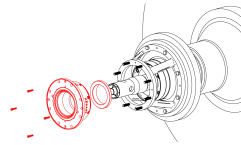

Step 6

Remove the ring bracket and wear plate. Discard the wear plate.

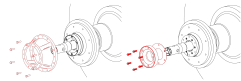

Step 7

Clean and inspect the head and body. Replace if damaged.

Step 8

Using a new gasket, install the PT2X wear plate (8A) with caps screws (16A).

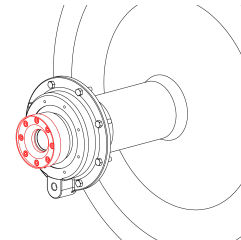

Step 9

Install the ring bracket with cap screws (20C).

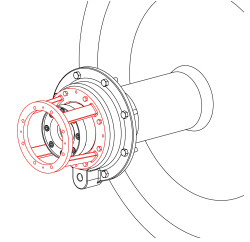

Step 10

Clean the mating surfaces of the PT2X wear plate, new seal ring (6), and nipple. Attach the PT2X seal ring and end cap assembly with four cap screws (3C).

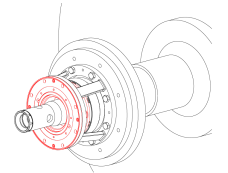

Tip: From the inside of the seal ring, use your finger tips to balance the seal ring while installing the end cap assembly.

Important: After fastening the end cap assembly, the groove with the dimple should be within the viewing window. If not, the setup dimension is incorrect, please contact Kadant Johnson.



Pinch hazard during end cap assembly installation.



Spring force present during end cap assembly installation.

Step 11

If there is an O-ring present on the support tube, remove it. Lubricate and install a new O-ring with silicone lubricant. Apply anti-seize to the tapered portion of the tube.

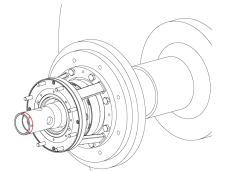

Step 12

Install a new O-ring (26) into the body. Position the body over the support tube. Align the pin(s) with the support tube indexing slots. Position both over the studs on the ring bracket and secure with hex nuts (20B).

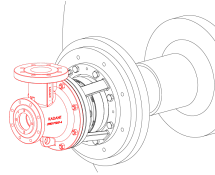

Step 13

Install a new O-ring in the support tube nut and apply anti-seize to the threads. Insert two bent lock washer tabs into the body and install the support tube nut, torque to 400 ft-lbs (542 Nm). Bend two lock washer tabs over the bolt flats to prevent bolt loosening.

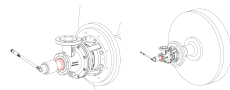

Step 14

Place gasket (8) on head and install head on body with cap screws (2A). Connect piping.

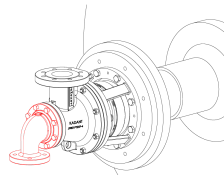

IS-9800PTX-to-PT2X-Conversion

The Kadant Johnson Warranty

Kadant Johnson products are built to a high standard of quality. Performance is what you desire: that is what we provide. Kadant Johnson products are warranted against defects in materials and workmanship for a period of one year after the date of shipment. It is expressly understood and agreed that the limit of Kadant Johnson's liability shall, at Kadant Johnson's sole option, be the repair or resupply of a like quantity of non-defective product.

Kadant Johnson rotary joints and accessories could be subject to European Pressure Equipment Directive 2014/68/EU (PED). Modifications or changes to rotary joints and/or accessories are only permitted upon approval of Kadant Johnson. Only genuine Kadant parts and original accessories will ensure the safety of these

assemblies. The use of other than original parts voids the warranty and will lead to forfeiture of the declaration of conformity and will invalidate any liability for damages caused thereby.